

1. CARBURETOR

1. CARBURETOR

a. REMOVAL/INSTALLATION

⚠ WARNING

Gasoline is highly flammable and explosive. You can be burned or seriously injured when handling fuel. Keep heat, sparks, and flame away. Wipe up spills immediately.

- 1) Remove the engine cover (P. 4-1) and fan cover (P. 5-1).
- 2) Completely drain the carburetor by loosening the drain screw.

CAUTION

Cover the intake port with a clean tape or film to prevent dirt from entering the engine. If these parts are left out, dirt will enter the intake system, damaging the engine.

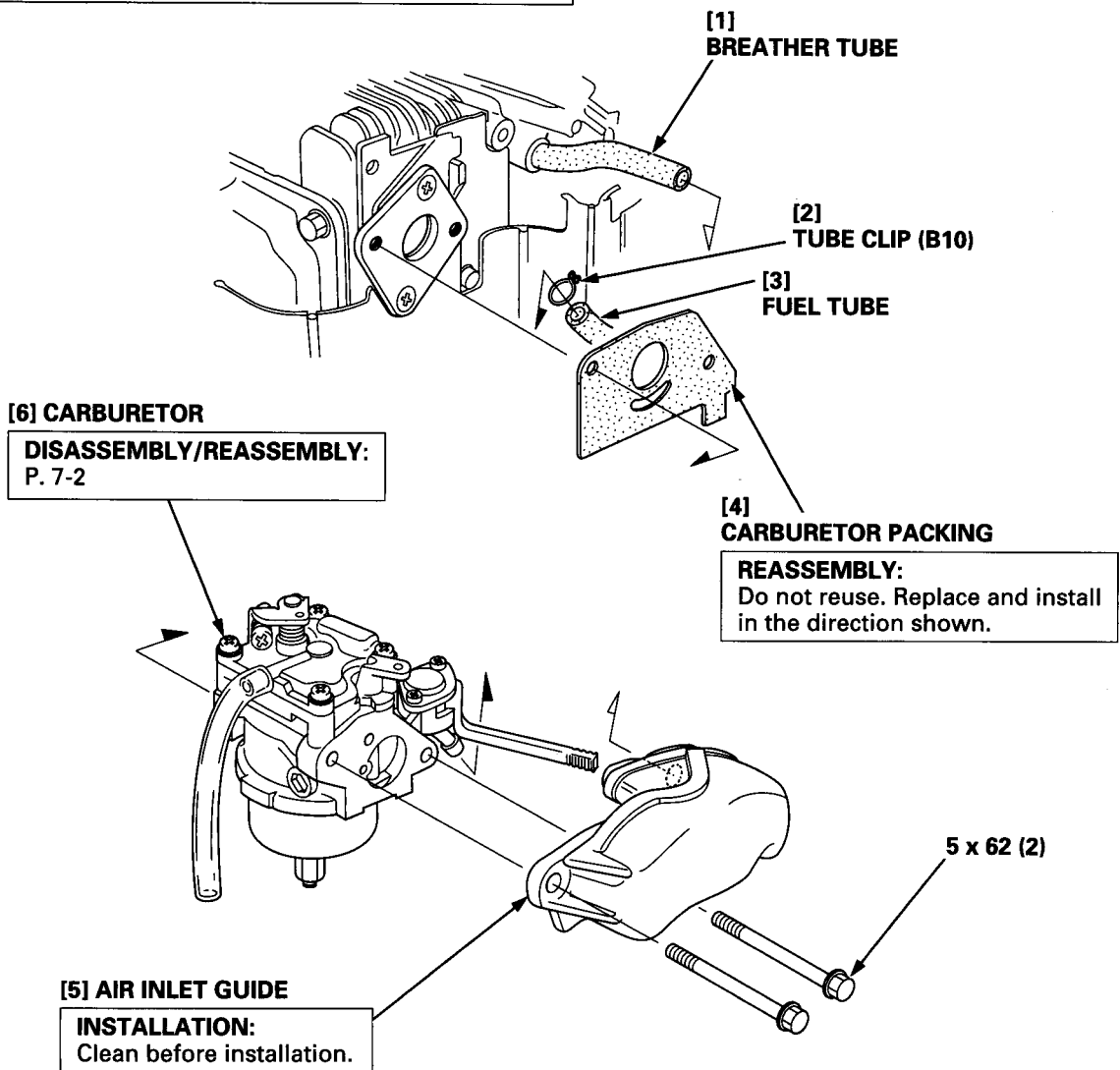

b. DISASSEMBLY/REASSEMBLY

⚠ WARNING

- Gasoline is highly flammable and explosive. You can be burned or seriously injured when handling fuel. Keep heat, sparks, and flame away. Wipe up spills immediately.
- Drain the carburetor thoroughly before removing the carburetor.

[5] PILOT JET

REASSEMBLY:

- Clean the passage by blowing compressed air before installation.
- To facilitate installation, apply light coat of oil to the O-ring.

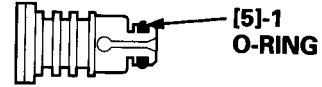

[5]-1
O-RING

[4] 4 x 12 mm SCREW (4)

[3] CARBURETOR BODY COVER

[2] AIR VENT TUBE

[1] THROTTLE STOP SCREW
ADJUSTMENT: P. 3-5

[6] O-RING

[7] 3 x 6 mm SCREW (2)

[8] LEVER SETTING PLATE

[9] LEVER SPRING

[10] FUEL VALVE LEVER

[24] CARBURETOR BODY

REASSEMBLY:
Clean by blowing compressed air before installation.

[23] PILOT SCREW

ADJUSTMENT: P. 3-5

[11] FUEL VALVE PACKING

REASSEMBLY:
Check the packing for wear and damage before installation.

[12] MAIN NOZZLE

REASSEMBLY:

Clean the passage by blowing compressed air before installation.

[12]-1
MAIN NOZZLE

[22] FLOAT VALVE

REASSEMBLY:

Check the valve tip for wear and the valve spring for operation.

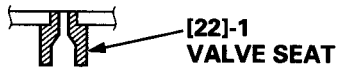

[22]-1
VALVE SEAT



[22]-4 [22]-2
NORMAL WORN

[22]-3
FLOAT VALVE

[21] FLOAT PIN

[13] MAIN JET

REASSEMBLY:

Clean the passage by blowing compressed air before installation. Main jet: #65

[13]-1
MAIN JET

[20] FLOAT CHAMBER GASKET

[19] FLOAT CHAMBER

REASSEMBLY:

Install in the direction shown.

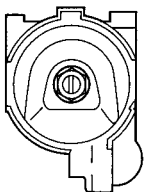

[18] SEALING WASHER

[15] O-RING

[14] FLOAT

REASSEMBLY:

After installation, check the float operation by pushing the float tip lightly with a finger. INSPECTION: P. 7-3

[17] SETTING BOLT

[16] DRAIN SCREW

REASSEMBLY:
After installation, check for gasoline leakage.

1.5 N·m (0.15 kgf·m, 1.1 lbf·ft)

c. INSPECTION

• FLOAT LEVEL HEIGHT

With the carburetor in an upright, measure the distance between the float top and carburetor body when the float just contacts the float valve.

Standard float height	12.0 mm (0.47 in)
-----------------------	-------------------

If the height is out of specification, replace the float.
Check the float operation.

